

24 volt D.C. PRESSURISED WATER SYSTEM for boats

CW332

- stainless steel jet centrifugal pump
- delivers up to 50 litres/minute
- pressures up to 2.5 bar (37 psi)
- virtually silent running
- compact installation
- for heavy use on larger vessels
- separate accumulator tank with bracket

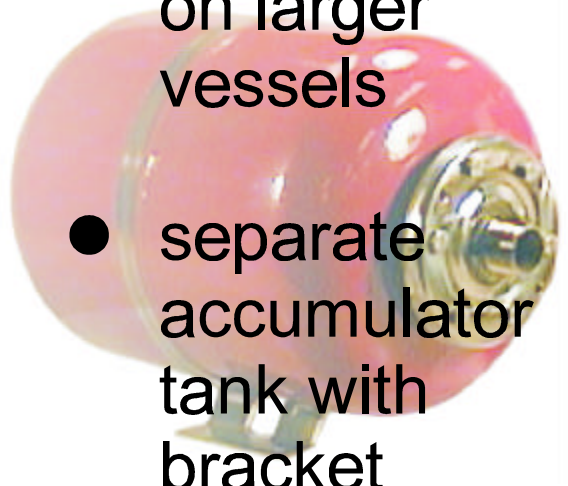
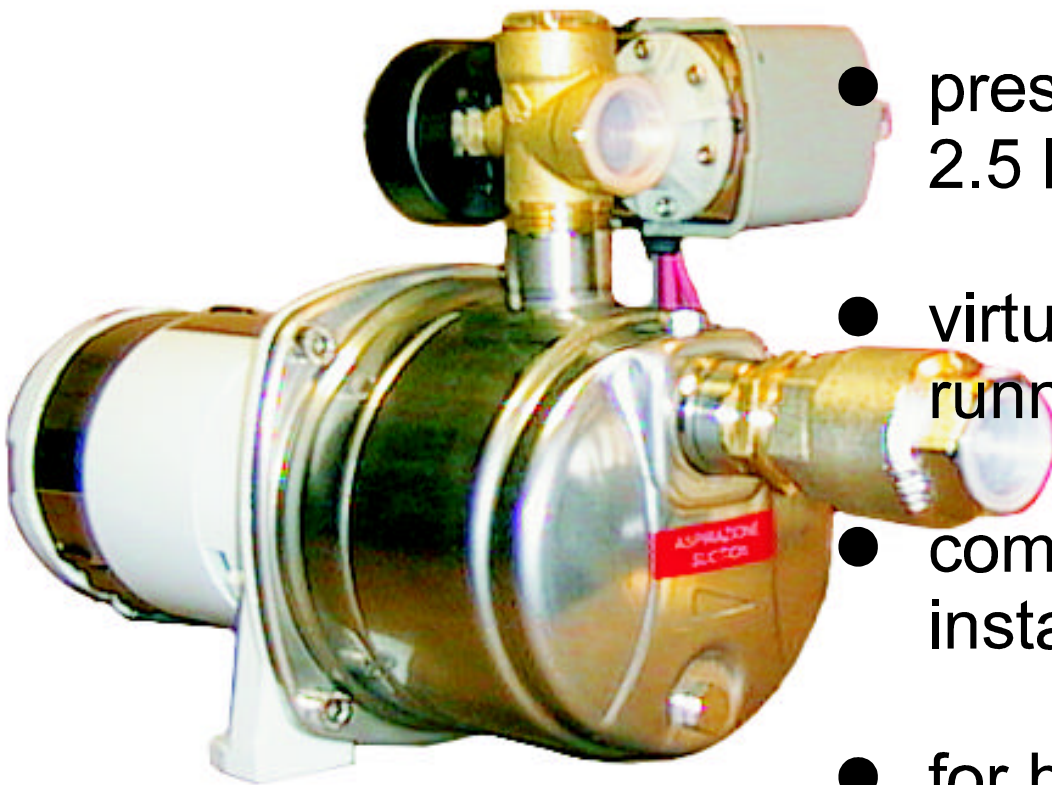

**CLEGHORN
WARING
PUMPS**

PRESSURISED WATER SYSTEM 24 volt DC

CW332

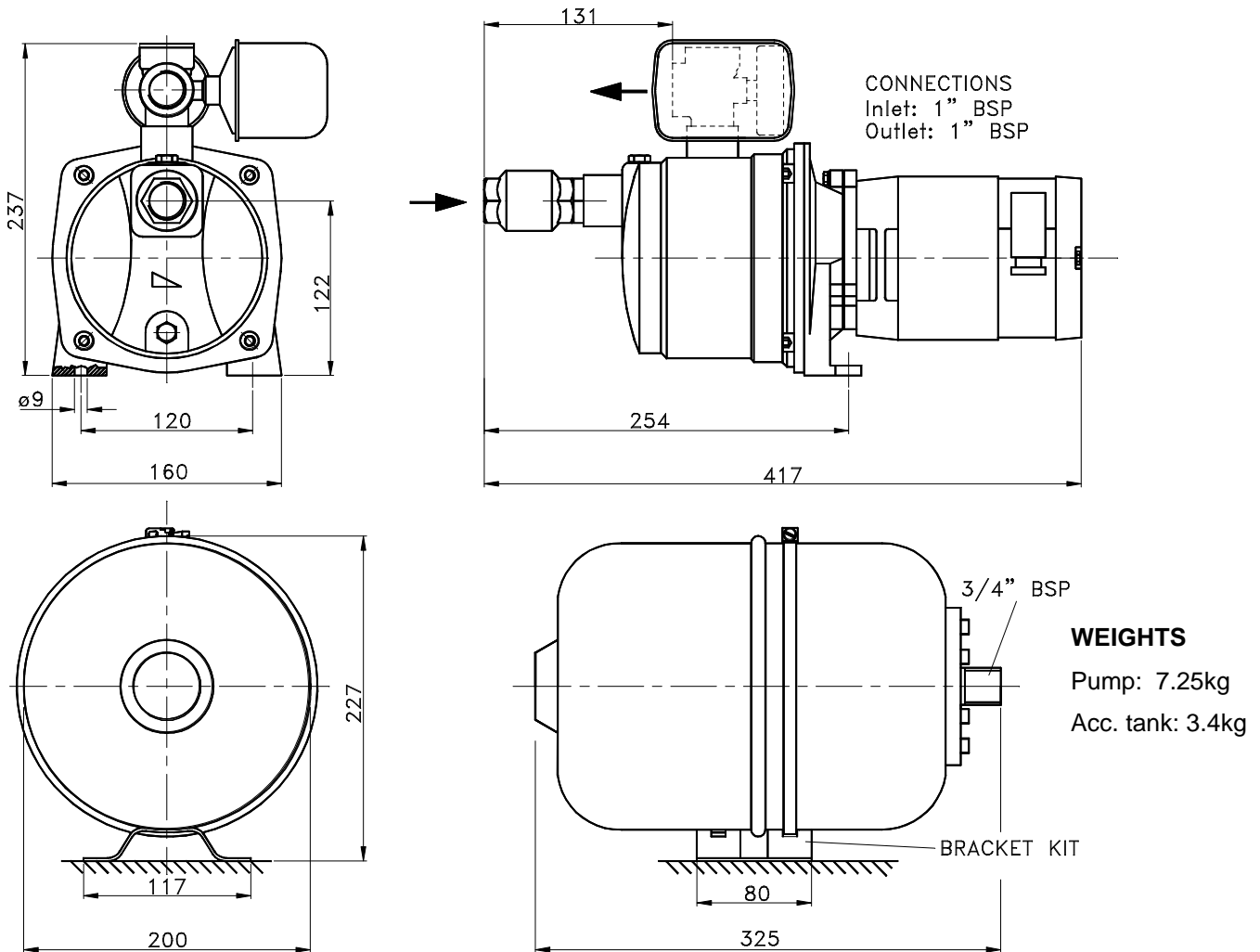

Complete self-priming system with heavy duty adjustable pressure switch, pressure gauge, and separate 8 litre accumulator tank with mounting bracket

CONSTRUCTION:

Pump casing, impeller: AISI304 stainless steel
Impeller: polymer
Shaft: AISI316 stainless steel
Shaft seal: mechanical carbon-ceramic
Accumulator tank: painted steel with rubber membrane
Accumulator tank bracket: painted steel with stainless steel strap.

PERFORMANCE:

Output: up to 50 litres/minute
(11 gallons/minute) open flow
Pressure switch cuts in at 1 bar (15 psi)
cuts out at 2 bar (29 psi)
Accumulator tank nominal capacity 8 litres.
Working volume approx 4 litres

MOTOR:

0.3 kW 24 volt d.c.
Full load current 16 amps
Recommended fuse size: 25 amps
Enclosure: IP22 Insulation class F
Noise level: As low as 55dB(A)